

NOTE
 1. THIS PAVEMENT DEPTH IS RECOMMENDED ONLY IN RESIDENTIAL STREETS WITH SAND SUB-GRADES WITH A MINIMUM DEPTH 0m 1m TO THE MAXIMUM WATER TABLE LEVEL
 2. IN THE CASE OF SOILS CONTAINING SILTS, CLAYS, PEAT OR IN CASES CLOSER THAN 1m TO THE MAXIMUM WATER TABLE, SPECIFIC PAVEMENT DESIGNS SHOULD BE UNDERTAKEN IN LINE WITH STANDARDS AUSTRALIA/AUSTROADS PAVEMENT DESIGN MANUAL OR APRG REPORT No 21, A GUIDE TO THE DESIGN OF NEW PAVEMENTS FOR LIGHT TRAFFIC AS APPLICABLE
 3. WHERE THE ROAD CARRIES TRAFFIC GREATER THAN 1x10⁶ EQUIVALENT STANDARD AXLES OVER A 20 YEAR DESIGN LIFE, THE PAVEMENT PROFILE SHOULD BE SUBJECT TO SPECIFIC DESIGN.

BACKFILL TO BE CONSOLIDATED TO 90% MODIFIED M.D.D. FOR A DISTANCE OF 600mm FROM BACK OF KERB PRIOR TO LAYING OF ASPHALT

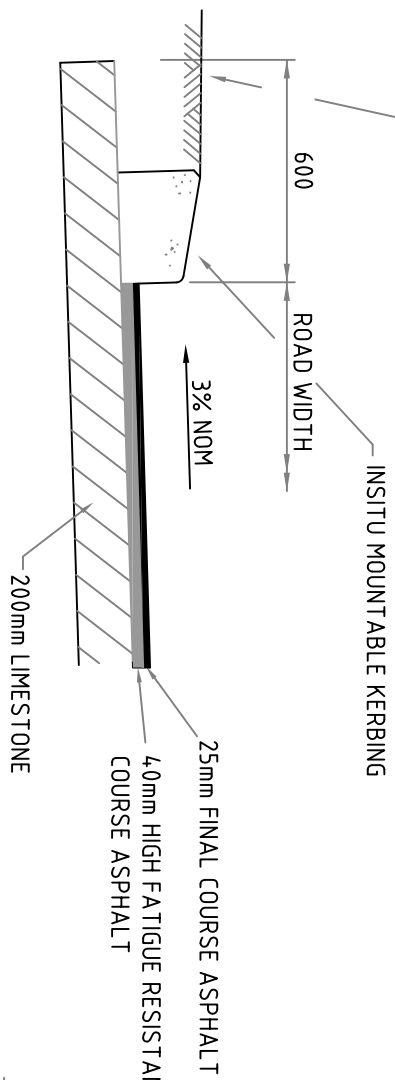

TYPICAL PAVEMENT DETAIL
 1:20

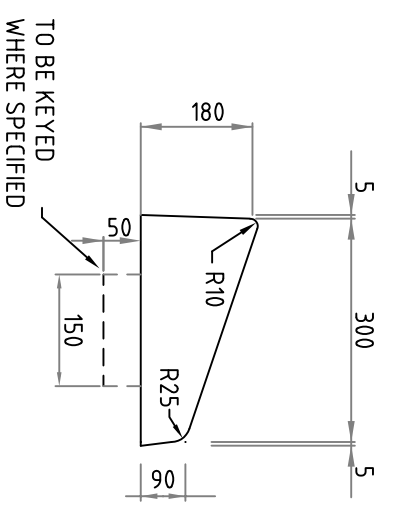

MOUNTABLE

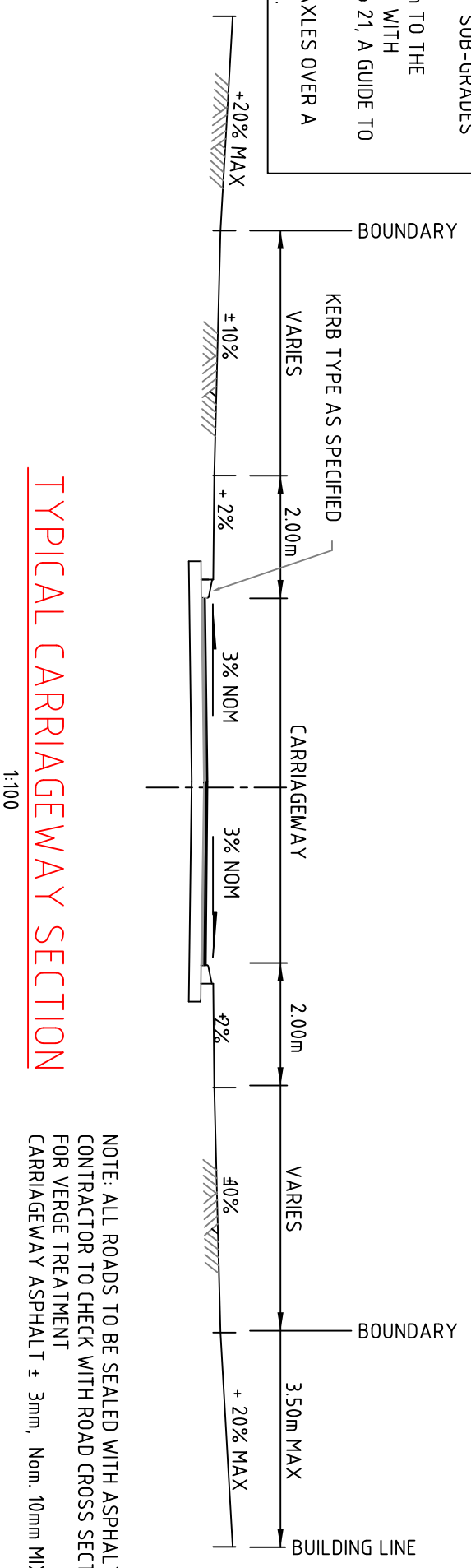

TYPICAL CARRIAGEWAY SECTION
 1:100

APPROVED INTERLOCKING PAVING WHEN USING 60 THICK BLOCK PAVING USE 200 THICK LIMESTONE SUB-BASE

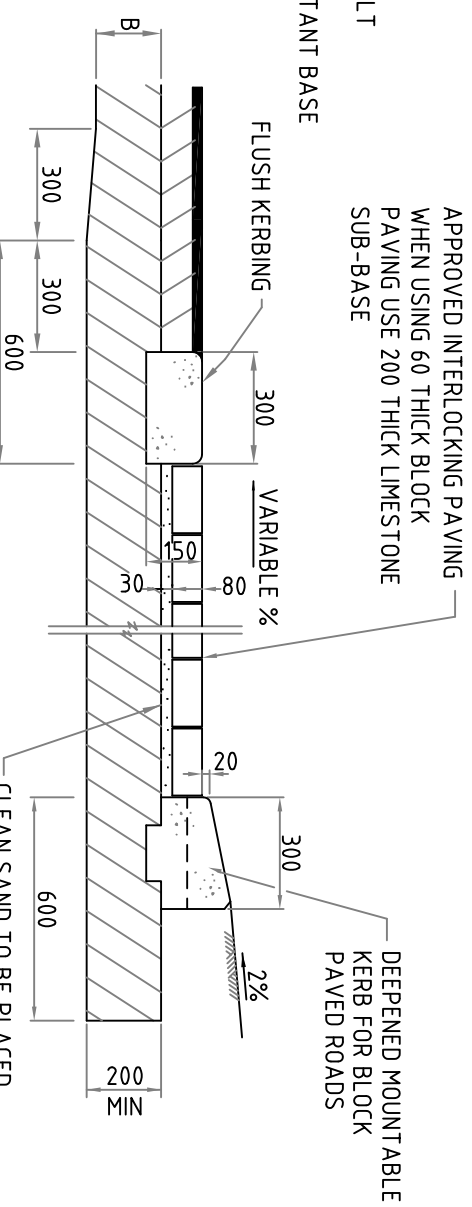

STANDARD BLOCK PAVING
 INCLUDING FLUSH KERBING 1:20

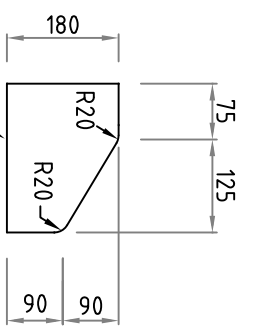

SEMI-MOUNTABLE

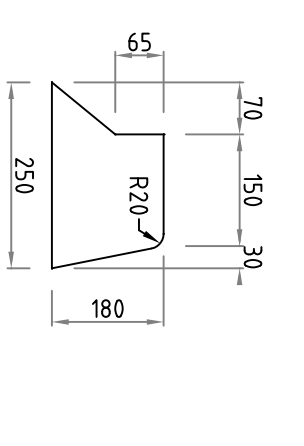

FOR USE AROUND PUBLIC OPEN SPACE

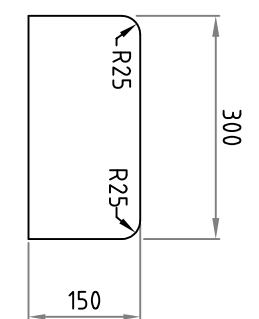

FLUSH

NOTE:
 WHERE KERB OCCURS ON RADII LESS THAN 4.0m OR ON ISLANDS, KERBS SHALL BE KEYPED

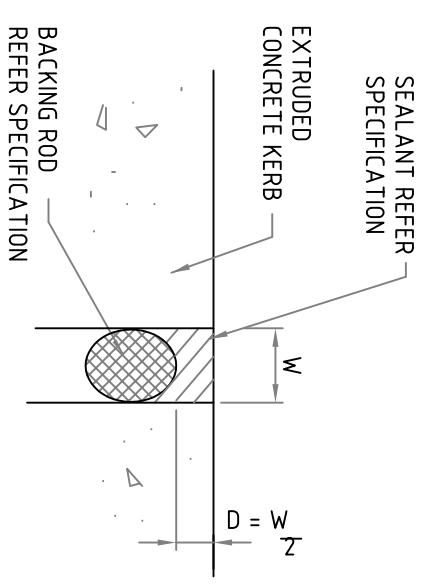
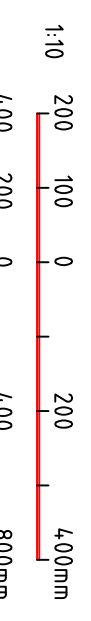

KERB EXPANSION JOINT DETAIL
 N.T.S

STANDARD EXTRUDED KERBING SECTIONS
 1:10

FOR USE ON MEDIAN AND SPLINTER ISLANDS AND ROAD INTERSECTIONS AND IN INDUSTRIAL AREA

Revision-		City of Cockburn would like to acknowledge and thank GutteridgeHaskins & Davey Pty. Ltd. for their assistance in the production of these standard detail drawings	
0.	Chk'd App'd Date	CITY OF COCKBURN 9 COLEVILLE CRESCENT, SPEARWOOD WA 6163 PHONE: (08) 9411 3444 FAX: (08) 9411 3416	
Title		ROADWORKS	
DESIGNED GHD		ROAD PAVEMENT & KERB DETAILS	
DRAWN KMF/SYC		SCALE AS SHOWN	
CHECKED KR		JOB No	
DATE		SHEET No	
		REV	
		2423B03 01 B	