

LOCK JOINT MUST ONLY BE INSTALLED ON CLEAN SAND FILL, EVENLY SCREDED, WATERED AND WELL COMPACTED TO A MINIMUM DEPTH OF 500mm AND 95% MODIFIED MAXIMUM DRY DENSITY. (OR TO ENGINEERS SPECIFICATIONS) CONCRETE SHOULD BE AT LEAST 32mpa.

**LOCK JOINT & EXPANSION JOINT DETAIL FOR CYCLEWAY & PATH**  
NTS

**PLAN - CYCLE SAFETY BARRIERS / FOOTPATH DETAILS**  
1: 100

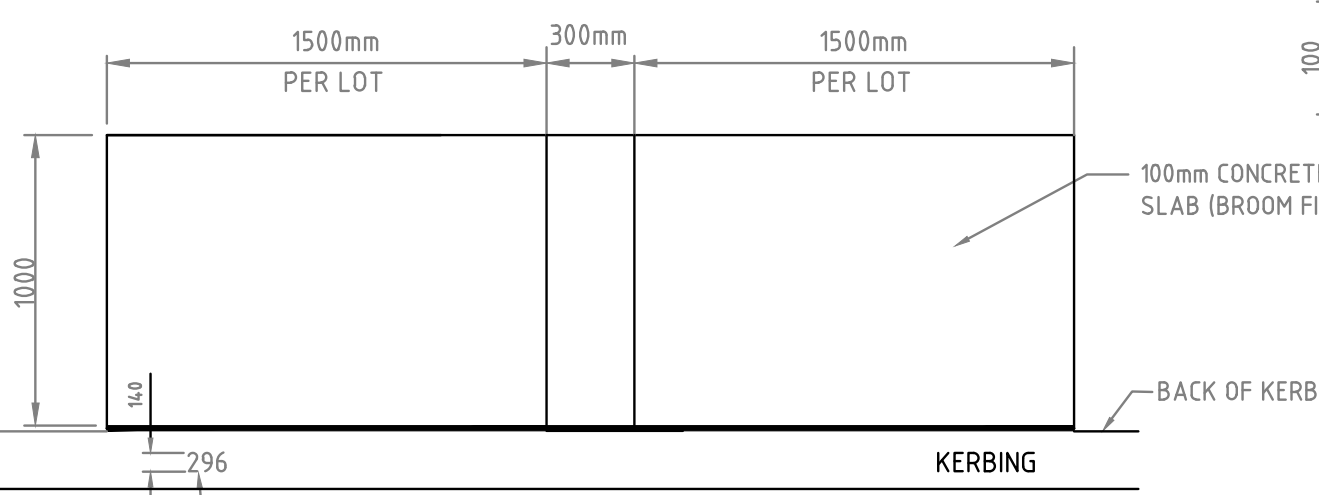

**BIN PAD DETAILS**

HOUSE NUMBERS TO BE 140mm HIGH REFLECTIVE YELLOW ON A MATT OLIVE GREEN BACKGROUND. 30mm BORDER AROUND

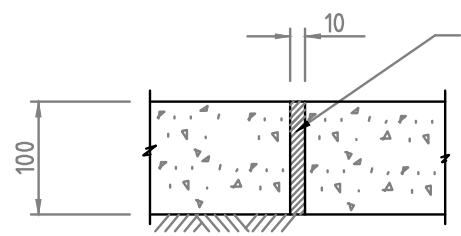

**EXPANSION JOINT**  
NTS

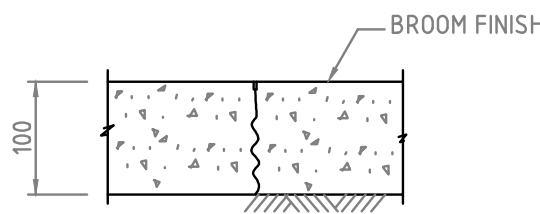

**LOCK JOINT**  
NTS

**NOTES**

- FOUNDATION TO BE COMPACTED TO MINIMUM 95% MODIFIED MDD TO A MIN DEPTH OF 500mm
- ALL CONCRETE FOR FOOTPATH CONSTRUCTION TO BE A MINIMUM OF 32MPa, 20mm AGGREGATE AND A MAXIMUM SLUMP OF 100mm
- MINIMUM THICKNESS 100mm (TOLERANCE -0mm, +10mm)
- LOCK JOINT EVERY 4.0m ( EXPANSION JOINT EVERY 20m ON STRAIGHT SECTIONS)
- TRANSVERSE EXPANSION JOINTS 10mm THICK ARE TO BE CONSTRUCTED AT 20m INTERVALS OR AS SHOWN ON THE DRAWINGS FOR THE FULL DEPTH OF THE PATH. THEY SHALL BE PLACED AT RIGHT ANGLES TO THE CENTRE LINE OF THE PATH. THIS REQUIREMENT WILL BE CLOSELY SUPERVISED. THE EXPANSION JOINT MATERIAL SHALL BE CONTINUOUS FROM FORM TO FORM EXTEND VERTICALLY TO THE FULL DEPTH OF THE SLABS AND SHALL BE STIFF JOINT OR A MATERIAL APPROVED BY THE CITY. THE JOINT MATERIAL SHALL AT NO POINT PROTRUDE ABOVE THE SURFACE OR RECESSED BELOW SURFACE OF THE PATH.
- FINISH - BROOMED TO NON - SKID FINISH, PICTURE FRAMING AT EDGES.
- WORKS SHALL BE UNDERTAKEN TO THE FOLLOWING TOLERANCES:
  - GRADE- 2% (FROM PROPERTY BOUNDARY) ± 0.5%
  - EXPANSION JOINT SPACING 20m ±100mm
  - SURFACE IRREGULARITIES ± 3mm
  - PATH WIDTH- -0mm, +20mm.
- FOR ASPHALT SHARED PATH-7mm DENSE GRADED ASPHALT WITH 2% RED-OXIDE
- FORMS ARE NOT TO BE REMOVED FROM THE CONCRETE WITHIN A TIME PERIOD OF AT LEAST 8 HRS.
- PATH SHALL BE 100mm THICK FOR GENERAL PURPOSE AND 150mm THICK FOR INDUSTRIAL AREAS WHERE, SUBJECT TO VEHICLE USAGE AND THE SATISFACTION OF THE CITY.
- ABLEFLEX TO BE USED WHEN FOOTPATH LOCKED BETWEEN KERB AND WALL-ON WALL SIDE ONLY AND AROUND FURNITURES SUCH AS LIDS AND POLES.

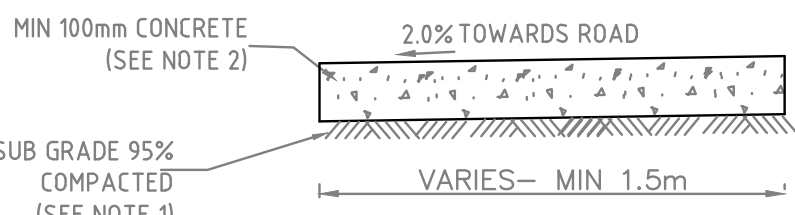

**FOOTPATH (CONCRETE) - CROSS SECTION**

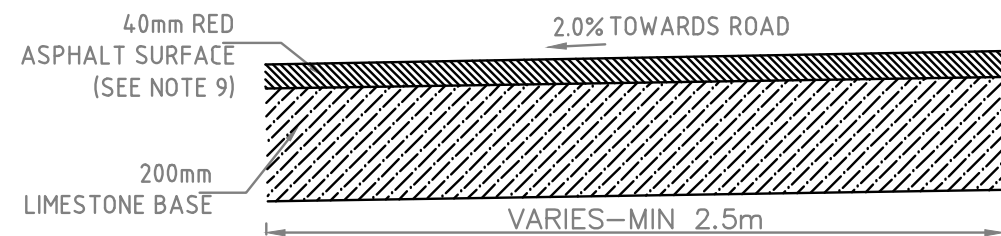

**SHARED PATH (ASPHALT) - CROSS SECTION**

G	NOTES BEEN AMENDED		03/03/21
F			12/02/21
E			03/12/20
D			20/09/19
C			31/08/18
Document Set ID: 6490888		Chk'd	App'd
Version: 7, Version 03/2021		Date	

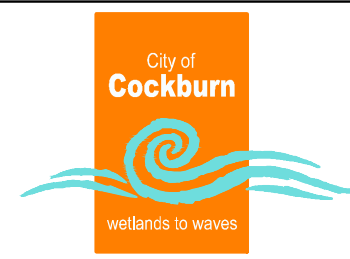

**CITY OF COCKBURN**  
9 COLEVILLE CRESCENT,  
SPEARWOOD WA 6163  
PHONE: (08) 9411 3444

**STANDARD DETAILS**

Title		<b>ROADWORKS CYCLEWAY/FOOTPATH DETAILS</b>		
DESIGNED	NS	APPROVED	SCALE AS SHOWN	JOB No
DRAWN	NS	DATE	DWG No	SHEET No
CHECKED			2423B03	06
				REV G